

NOTICE!!

These documents have been scanned!

Do not place un-scanned documents beneath this notice!

Do not remove this notice from this file!

GPO Jacket No. 560-102
Print Order 61540
Rise Business Services, LLC
Job=AZ15 5/13/2019



Box Number= AZ15038



Claim Begin-End: AMC424428-AMC424428

1 Initial Receipt



AZ15038-8

AMC423774-AMC424570

**United States Department of the Interior
Bureau of Land Management
LANDS/RECREATION & PLANNING
ONE N CENTRAL AVE
PHOENIX, AZ 85004 -2203
Phone: 602-417-9200**

Receipt

No: 2839960

Transaction #: 2925544		ENTERED SEP 03 2013
Date of Transaction: 07/25/2013		
CUSTOMER:		
LARRY SELBERG PO BOX 7434 CHANDLER, AZ 85246-7434 US	BY: <u>LS</u>	SEP 03 2013

LINE #	QTY	DESCRIPTION	REMARKS	UNIT PRICE	TOTAL
1	1.00	LOCATABLE MINERALS / MINING CLAIMS-NEW, UNADJUD, ONE OR MORE AUTH NOS / NEW MINING CLAIM LOCATION FEE \$34 CASES: AMC424428/\$34.00		- n/a -	34.00
2	1.00	LOCATABLE MINERALS / MINING CLAIMS-NEW, UNADJUD, ONE OR MORE AUTH NOS / NEW MINING CLAIM PROCESSING FEE \$15 CASES: AMC424428/\$15.00		- n/a -	15.00
3	1.00	LOCATABLE MINERALS / MINING CLAIMS-NEW, UNADJUD, ONE OR MORE AUTH NOS / NEW MINING CLAIM MAINT FEE \$140 CASES: AMC424428/\$140.00		- n/a -	140.00
4	1.00	LOCATABLE MINERALS / MINING CLAIMS-NOT NEW-UNADJUD, ONE AUTH NO. ONLY / MINING CLAIM MONEY RECEIVED CASES: AMC424428/\$140.00	MAINT FEE PYMNT (1) 2014	n/a -	140.00
5	1.00	LOCATABLE MINERALS / MINING CLAIMS-NOT NEW-UNADJUD, ONE AUTH NO. ONLY / MINING CLAIM MONEY RECEIVED CASES: AMC423147/\$280.00	MAINT FEE PYMNT (2) 2014	- n/a -	280.00
TOTAL:					\$609.00

ENTERED
M. Fee
SEP 03 2013
2013

M/F
SEP 03 2013
PB

8/7/13
TS

PAYMENT INFORMATION				
1	AMOUNT:	609.00	POSTMARKED:	N/A
	TYPE:	CHECK	RECEIVED:	07/25/2013
	CHECK NO:	9236		
	NAME:	SELBERG, LARRY C		

	PO BOX 7434 CHANDLER AZ 85246-7434 US
--	--

REMARKS

This receipt was generated by the automated BLM Collections and Billing System and is a paper representation of a portion of the official electronic record contained therein.

NOTICE!!

These documents have been scanned!

Do not place un-scanned documents beneath this notice!

Do not remove this notice from this file!

GPO Jacket No. 560-102
Print Order 61540
Rise Business Services, LLC
Job=AZ15 5/13/2019



Box Number= AZ15038



Claim Begin-End: AMC424428-AMC424428

2 Correspondence



AZ15038-8

AMC423774-AMC424570

**NO
DOCUMENTS
FOUND**

NO DOCUMENTS FOUND
NO DOCUMENTS FOUND

NOTICE!!

These documents have been scanned!

Do not place un-scanned documents beneath this notice!

Do not remove this notice from this file!

GPO Jacket No. 560-102
Print Order 61540
Rise Business Services, LLC
Job=AZ15 5/13/2019



Box Number= AZ15038



Claim Begin-End: AMC424428-AMC424428

3 Transfers



AZ15038-8

AMC423774-AMC424570

**NO
DOCUMENTS
FOUND**

NO DOCUMENTS FOUND
NO DOCUMENTS FOUND

NOTICE!!

These documents have been scanned!

Do not place un-scanned documents beneath this notice!

Do not remove this notice from this file!

GPO Jacket No. 560-102
Print Order 61540
Rise Business Services, LLC
Job=AZ15 5/13/2019



Box Number= AZ15038



Claim Begin-End: AMC424428-AMC424428

4 Miscellaneous



AZ15038-8

AMC423774-AMC424570

**NO
DOCUMENTS
FOUND**

NO DOCUMENTS FOUND
NO DOCUMENTS FOUND

NOTICE!!

These documents have been scanned!

Do not place un-scanned documents beneath this notice!

Do not remove this notice from this file!

GPO Jacket No. 560-102
Print Order 61540
Rise Business Services, LLC
Job=AZ15 5/13/2019



Box Number= AZ15038



Claim Begin-End: AMC424428-AMC424428

5 Annual Filings



AZ15038-8

AMC423774-AMC424570

418698

424428

423147

MAINTENANCE FEE PAYMENT

Claimant Name: LARRY SELBERG
 Address: P.O. Box 7434
 City: CHANDLER State: AZ Zip: 85246
 Telephone: 480-789-2863
 E-mail address: L-SELBERG@Yahoo.com
 Signature: Larry Selberg

RECEIVED
 STATE OFFICE
 PHOENIX, ARIZONA
 2018 JUL 30 A 11: 14
 BLM
 Date
 Stamp

Check here if this is a change of address.

LINE NO.	AMC NUMBER	CLAIM/SITE NAME	COUNTY RECORDER DATA (if available)	TWP	RNG	SEC
1	418698	Billie R		9N	5W	25
2						
3						
4						
5						
6						
7						
8						
9						
10						

List additional claims on Form MCF114.

Bureau of Land Management
 Arizona State Office
www.blm.gov/az/

No. of Claims*: 1 x \$155 = 155.00
 Check No: _____ Init. _____
 Receipt No.: 4231815
 For BLM Use Only

* \$155 per lode mining claim, mill site, or tunnel site; and \$155 for each 20 acres or portion thereof for each placer mining claim.

Form: MCF112
Revised July 2014

This form is available from the Arizona Geological Survey and may be reproduced.

RECEIVED
 AUG 01 2018
 BY: RAM

MAINTENANCE FEE PAYMENT

Claimant Name: LARRY SELBERG
 Address: P.O. Box 7434
 City: CHANDLER State: AZ Zip: 85246
 Telephone: (480) 789-2863
 E-mail address: L-SELBERG@Yahoo.com
 Signature: Larry Selberg

RECEIVED
 ARIZONA STATE OFFICE
 PHOENIX, ARIZONA
 2010 JUL 30 A 11:14
 BLM
 Date
 Stamp

Check here if this is a change of address.

LINE NO.	AMC NUMBER	CLAIM/SITE NAME	COUNTY RECORDER DATA (If available)	TWP	RNG	SEC
1	424428	GOLD Gulch		9N	5W	13
2	423147	HAVALINA #1		9N	5W	13
3	423148	HAVALINA #2		9N	5W	13
4						
5						
6						
7						
8						
9						
10						

List additional claims on Form MCF114.

Bureau of Land Management
Arizona State Office
www.blm.gov/az/

No. of Claims*: 3 x \$155 = 465.00
 Check No: _____ Init. _____
 Receipt No.: _____
For BLM Use Only

* \$155 per lode mining claim, mill site, or tunnel site; and \$155 for each 20 acres or portion thereof for each placer mining claim.

Form: MCF112
 Revised July 2014

United States Department of the Interior
Bureau of Land Management
 DIV OF LANDS, MINRLS & ENERGY
 ONE N CENTRAL AVE
 PHOENIX, AZ 85004 -4427
 Phone: 602-417-9200

Receipt

No: 4221815

Transaction #: 4337030	
Date of Transaction: 07/30/2018	
CUSTOMER:	
LARRY SELBERG PO BOX 7434 CHANDLER, AZ 85246-7434 US	

LINE #	QTY	DESCRIPTION	REMARKS	UNIT PRICE	TOTAL
1	1.00	LOCATABLE MINERALS / MINING CLAIMS- NOT NEW-UNADJUD, ONE AUTH NO. ONLY / MINING CLAIM MONEY RECEIVED CASES: AMC418698/\$620.00	MAINT 2019/4	- n/a -	620.00
TOTAL:					\$620.00

PAYMENT INFORMATION			
1	AMOUNT:	620.00	POSTMARKED: N/A
	TYPE:	CHECK	RECEIVED: 07/30/2018
	CHECK NO:	9710	
	NAME:	SELBERG, LARRY PO BOX 7434 CHANDLER AZ 85246-7434 US	

REMARKS

This receipt was generated by the automated BLM Collections and Billing System and is a paper representation of a portion of the official electronic record contained therein.

418698

424428

423147

MAINTENANCE FEE PAYMENT

Claimant Name: LARRY SELBERG
 Address: P.O. BOX 7434
 City: CHANDLER State: AZ Zip: 85246
 Telephone: 480-789-2863
 E-mail address: L-SELBERG@YAHOO.COM
 Signature: Larry Selberg

Check here if this is a change of address.

RECEIVED
 BLM AZ STATE OFFICE
 2017 JUL 31 A 10: 10
 PHOENIX, ARIZONA
 BLM
 Date
 Stamp

LINE NO.	AMC NUMBER	CLAIM/SITE NAME	COUNTY RECORDER DATA (If available)	TWP	RNG	SEC
1	418698	Billie R		9N	5W	25
2						
3						
4						
5						
6						
7						
8						
9						
10						

List additional claims on Form MCF114.

Bureau of Land Management
Arizona State Office
www.blm.gov/az/

No. of Claims*: 1 x \$155 = 155
 Check No: 9604 Init. MLC
 Receipt No.: 3912909
 For BLM Use Only

* \$155 per lode mining claim, mill site, or tunnel site; and \$155 for each 20 acres or portion thereof for each placer mining claim.

Form: MCF112
Revised July 2014

This form is available from the Arizona Geological Survey and may be reproduced.

ENTERED
 AUG 01 2017
 BY: RAM

MAINTENANCE FEE PAYMENT

Claimant Name: LARRY SELBERG
 Address: P.O. Box 7434
 City: CHANDLER State: AZ Zip: 85246
 Telephone: 480-789-2863
 E-mail address: LSELBERG@Yahoo.com
 Signature: Larry Selberg

Check here if this is a change of address.

RECEIVED
 BLM AZ STATE OFFICE
 2011 JUL 31 A 10:10
 PHOENIX, ARIZONA
 BLM
 Date
 Stamp

LINE NO.	AMC NUMBER	CLAIM/SITE NAME	COUNTY RECORDER DATA (If available)	TWP	RNG	SEC
1	424428	GOLD GULCH		9N	5W	13
2	423147	HAVA LINA #1		9N	5W	13
3	423148	HAVA LINA #2		9N	5W	13
4						
5						
6						
7						
8						
9						
10						

List additional claims on Form MCF114.

Bureau of Land Management
 Arizona State Office
www.blm.gov/az/

No. of Claims*: 3 x \$155 = 465
 Check No: 9603 Init. HL
 Receipt No.: 3912909
 For BLM Use Only

* \$155 per lode mining claim, mill site, or tunnel site; and \$155 for each 20 acres or portion thereof for each placer mining claim.

Form: MCF112
 Revised July 2014

United States Department of the Interior
Bureau of Land Management
 DIV OF LANDS, MINRLS & ENERGY
 ONE N CENTRAL AVE
 PHOENIX, AZ 85004 -4427
 Phone: 602-417-9200

Receipt

No: 3912909

Transaction #: 4022349	
Date of Transaction: 07/31/2017	
CUSTOMER:	
LARRY SELBERG PO BOX 7434 CHANDLER, AZ 85246-7434 US	

LINE #	QTY	DESCRIPTION	REMARKS	UNIT PRICE	TOTAL
1	1.00	LOCATABLE MINERALS / MINING CLAIMS- NOT NEW-UNADJUD, ONE AUTH NO. ONLY / MINING CLAIM MONEY RECEIVED CASES: AMC418698/\$620.00	MAINT 2018/4	- n/a -	620.00
TOTAL:					\$620.00

PAYMENT INFORMATION			
1	AMOUNT:	465.00	POSTMARKED: N/A
	TYPE:	CHECK	RECEIVED: 07/31/2017
	CHECK NO:	9603	
	NAME:	SELBERG, LARRY PO BOX 7434 CHANDLER AZ 85246-7434 US	
2	AMOUNT:	155.00	POSTMARKED: N/A
	TYPE:	CHECK	RECEIVED: 07/31/2017
	CHECK NO:	9604	
	NAME:	SELBERG, LARRY PO BOX 7434 CHANDLER AZ 85246-7434 US	

REMARKS

This receipt was generated by the automated BLM Collections and Billing System and is a paper representation of a portion of the official electronic record contained therein.

424428
423147

MAINTENANCE FEE PAYMENT

Claimant Name: LARRY SELBERG
 Address: P.O. BOX 7434
 City: CHANDLER State: AZ Zip: 85246
 Telephone: (480) 789-2863
 E-mail address: L-SELBERG@YAHOO.COM
 Signature: [Signature]

BLM
Date
Stamp

2016 JUL -6 P 12:03
 MARICOPA COUNTY, ARIZONA
 ARIZONA STATE OFFICE

Check here if this is a change of address.

LINE NO.	AMC NUMBER	CLAIM/SITE NAME	COUNTY RECORDER DATA (If available)	TWP	RNG	SEC
1	424428	GOLD GULCH		9N	5W	13
2	423147	HAVALINA #1		9N	5W	13
3	423148	HAVALINA #2		9N	5W	13
4						
5						
6						
7						
8						
9						
10						

List additional claims on Form MCF114.

No. of Claims*: 3 x \$155 = 465⁰⁰
 Check No: 9492 Init. PETC
 Receipt No.: 360063
For BLM Use Only

Bureau of Land Management
Arizona State Office
www.blm.gov/az/

* \$155 per lode mining claim, mill site, or tunnel site; and \$155 for each 20 acres or portion thereof for each placer mining claim.

Form: MCF112
 Revised July 2014

This form is available from the **Arizona Geological Survey** and may be reproduced.

ENTERED
 JUL 07 2016
 BY: RAM

United States Department of the Interior
Bureau of Land Management
 DIV OF LANDS, MINRLS & ENERGY
 ONE N CENTRAL AVE
 PHOENIX, AZ 85004 -4427
 Phone: 602-417-9200

Receipt

No: 3600063

Transaction #: 3703411	
Date of Transaction: 07/06/2016	
CUSTOMER:	
LARRY SELBERG PO BOX 7434 CHANDLER, AZ 85246-7434 US	

LINE #	QTY	DESCRIPTION	REMARKS	UNIT PRICE	TOTAL
1	1.00	LOCATABLE MINERALS / MINING CLAIMS- NOT NEW-UNADJUD, ONE AUTH NO. ONLY / MINING CLAIM MONEY RECEIVED CASES: AMC424428/\$465.00	2017 MAINT/3	- n/a -	465.00
TOTAL:					\$465.00

PAYMENT INFORMATION					
1	AMOUNT:	465.00	POSTMARKED:	N/A	
	TYPE:	CHECK	RECEIVED:	07/06/2016	
	CHECK NO:	9492			
	NAME:	SELBERG, LARRY PO BOX 7434 CHANDLER AZ 85246-7434 US			

REMARKS

This receipt was generated by the automated BLM Collections and Billing System and is a paper representation of a portion of the official electronic record contained therein.

418635
 418698
 424428
 423147

MAINTENANCE FEE PAYMENT

Claimant Name: LARRY SELBERG
 Address: PO Box 7434
 City: CHANDLER State: AZ Zip: 85246
 Telephone: (480) 789-2863
 E-mail address: L-SELBERG@Yahoo.COM
 Signature: Larry Selberg

RECEIVED
 AZ STATE OFFICE
 PHOENIX, ARIZONA
 2015 MAR 26 A 10:33
 BLM
 Date
 Stamp

Check here if this is a change of address.

LINE NO.	AMC NUMBER	CLAIM/SITE NAME	COUNTY RECORDER DATA (If available)	TWP	RNG	SEC
1	418635	DREAM CATCHER		9N	5W	25
2						
3						
4						
5						
6						
7						
8						
9						
10						

List additional claims on Form MCF114.

Bureau of Land Management
Arizona State Office
www.blm.gov/az/

No. of Claims*: 1 x \$155 = 155
 Check No: 9390 Init. ESG
 Receipt No.: 3258 281
 For BLM Use Only

* \$155 per lode mining claim, mill site, or tunnel site; and \$155 for each 20 acres or portion thereof for each placer mining claim.

Form: MCF112
 Revised July 2014

This form is available from the Arizona Geological Survey and may be reproduced.

ENTERED

MAY 01 2015

BY: Rohu

MAINTENANCE FEE PAYMENT

Claimant Name: LARRY SELBERG
 Address: P.O. Box 7434
 City: CHANDLER State: AZ Zip: 85246
 Telephone: (480) 789-2863
 E-mail address: L-SELBERG@YAHOO.COM
 Signature: Larry Selberg

RECEIVED
 AZ STATE OFFICE
 PHOENIX, ARIZONA
 2015 MAR 26 A 10:33
 BLM
 Date
 Stamp

Check here if this is a change of address.

LINE NO.	AMC NUMBER	CLAIM/SITE NAME	COUNTY RECORDER DATA (If available)	TWP	RNG	SEC
1	418698	Billie R		9N	5W	25
2						
3						
4						
5						
6						
7						
8						
9						
10						

List additional claims on Form MCF114.

No. of Claims*: 1 x \$155 = 155.00
 Check No: 9391 Init. ESG
 Receipt No.: _____
 For BLM Use Only

Bureau of Land Management
Arizona State Office
www.blm.gov/az/

* \$155 per lode mining claim, mill site, or tunnel site; and \$155 for each 20 acres or portion thereof for each placer mining claim.

Form: MCF112
 Revised July 2014

This form is available from the **Arizona Geological Survey** and may be reproduced.

MAY 01 2015

BY: RAM

MAINTENANCE FEE PAYMENT

Claimant Name: LARRY SELBERG
 Address: P.O. Box 7434
 City: CHANDLER State: AZ Zip: 85246
 Telephone: (480) 789-2863
 E-mail address: L-SELBERG@YHoo.com
 Signature: [Signature]

Check here if this is a change of address.

RECEIVED
 AZ STATE OFFICE
 2015 MAR 26 A 10:33
 PHOENIX, ARIZONA
 BLM
 Date
 Stamp

LINE NO.	AMC NUMBER	CLAIM/SITE NAME	COUNTY RECORDER DATA (If available)	TWP	RNG	SEC
1	424428	GOLD GULCH		9N	5W	13
2	423147	HAVALINA #1		9N	5W	13
3	423148	HAVA LINA #2		9N	5W	13
4						
5						
6						
7						
8						
9						
10						

List additional claims on Form MCF114.

No. of Claims*: 3 x \$155 = 465.00
 Check No: 9389 Init. [Signature]
 Receipt No.: _____
 For BLM Use Only

Bureau of Land Management
Arizona State Office
www.blm.gov/az/

* \$155 per lode mining claim, mill site, or tunnel site; and \$155 for each 20 acres or portion thereof for each placer mining claim.

Form: MCF112
 Revised July 2014

This form is available from the **Arizona Geological Survey** and may be reproduced.

ENTERED
 MAY 01 2015
 BY: [Signature]

United States Department of the Interior
Bureau of Land Management
 LANDS/RECREATION & PLANNING
 ONE N CENTRAL AVE
 PHOENIX, AZ 85004 -2203
 Phone: 602-417-9200

Receipt

No: 3258281

Transaction #: 3353701	
Date of Transaction: 03/26/2015	
CUSTOMER:	
LARRY SELBERG PO BOX 7434 CHANDLER, AZ 85246-7434 US	

LINE #	QTY	DESCRIPTION	REMARKS	UNIT PRICE	TOTAL
1	1.00	LOCATABLE MINERALS / MINING CLAIMS- NOT NEW-UNADJUD, ONE AUTH NO. ONLY / MINING CLAIM MONEY RECEIVED CASES: AMC418635/\$775.00	2016 MAINT (5)	- n/a -	775.00
TOTAL:					\$775.00

PAYMENT INFORMATION					
1	AMOUNT:	465.00	POSTMARKED:	N/A	
	TYPE:	CHECK	RECEIVED:	03/26/2015	
	CHECK NO:	9389			
	NAME:	SELBERG, LARRY			
2	AMOUNT:	155.00	POSTMARKED:	N/A	
	TYPE:	CHECK	RECEIVED:	03/26/2015	
	CHECK NO:	9390			
	NAME:	SELBERG, LARRY			
3	AMOUNT:	155.00	POSTMARKED:	N/A	
	TYPE:	CHECK	RECEIVED:	03/26/2015	
	CHECK NO:	9391			
	NAME:	SELBERG, LARRY			

REMARKS

This receipt was generated by the automated BLM Collections and Billing System and is a paper representation of a portion of the official electronic record contained therein.

ENTERED
 MAY 01 2015
 BY: *Ram*

418635
418698
424428
423147

MAINTENANCE FEE PAYMENT

Claimant Name: LARRY SELBERG
Address: PO Box 7434
City: CHANDLER State: AZ Zip: 85246
Telephone: (480) 789-2863
E-mail address: L-SELBERG@YAHOO.COM
Signature: Larry Selberg

RECEIVED
11 AZ STATE OFFICE
2015 MAR 26 A 10:33
PHOENIX, ARIZONA
BLM
Date
Stamp

Check here if this is a change of address.

LINE NO.	AMC NUMBER	CLAIM/SITE NAME	COUNTY RECORDER DATA (If available)	TWP	RNG	SEC
1	418635	DREAM CATCHER		9N	5W	25
2						
3						
4						
5						
6						
7						
8						
9						
10						

List additional claims on Form MCF114.

Bureau of Land Management
Arizona State Office
www.blm.gov/az/

No. of Claims*: 1 x \$155 = 155
Check No: 9390 Init. LSG
Receipt No.: 325828/
For BLM Use Only

* \$155 per lode mining claim, mill site, or tunnel site; and \$155 for each 20 acres or portion thereof for each placer mining claim.

Form: MCF112
Revised July 2014

This form is available from the **Arizona Geological Survey** and may be reproduced.

MAY 1 2015
BY: RAM

MAINTENANCE FEE PAYMENT.

Claimant Name: LARRY SELBERG
 Address: P.O. Box 7434
 City: CHANDLER State: AZ Zip: 85246
 Telephone: (480) 789-2863
 E-mail address: L-SELBERG@Yahoo.com
 Signature: Larry Selberg

Check here if this is a change of address.

RECEIVED
 AZ STATE OFFICE
 2015 MAR 26 A 10:33
 PHOENIX, ARIZONA
 BLM
 Date
 Stamp

LINE NO.	AMC NUMBER	CLAIM/SITE NAME	COUNTY RECORDER DATA (If available)	TWP	RNG	SEC
1	418698	Billie R		9N	5W	25
2						
3						
4						
5						
6						
7						
8						
9						
10						

List additional claims on Form MCF114.

Bureau of Land Management
Arizona State Office
www.blm.gov/az/

No. of Claims*: 1 x \$155 = 155.00
 Check No: 9391 Init. SSG
 Receipt No.: 3258281
 For BLM Use Only

* \$155 per lode mining claim, mill site, or tunnel site; and \$155 for each 20 acres or portion thereof for each placer mining claim.

Form: MCF112
 Revised July 2014

MAINTENANCE FEE PAYMENT

Claimant Name: LARRY SELBERG
 Address: P.O. Box 7434
 City: CHANDLER State: AZ Zip: 85246
 Telephone: (480) 789-2863
 E-mail address: L-SELBERG@Yahoo.com
 Signature: [Handwritten Signature]

Check here if this is a change of address.

RECEIVED
 AZ STATE OFFICE
 2015 MAR 26 A 10:33
 PHOENIX, ARIZONA
 BLM
 Date
 Stamp

LINE NO.	AMC NUMBER	CLAIM/SITE NAME	COUNTY RECORDER DATA (If available)	TWP	RNG	SEC
1	424428	GOLD GULCH		9N	5W	13
2	423147	HAVALINA #1		9N	5W	13
3	423148	HAVA LINA #2		9N	5W	13
4						
5						
6						
7						
8						
9						
10						

List additional claims on Form MCF114.

Bureau of Land Management
Arizona State Office
www.blm.gov/az/

No. of Claims*: 3 x \$155 = 465.00
 Check No: 9389 Init. [Signature]
 Receipt No.: 3258281
 For BLM Use Only

* \$155 per lode mining claim, mill site, or tunnel site; and \$155 for each 20 acres or portion thereof for each placer mining claim.

Form: MCF112
Revised July 2014

**United States Department of the Interior
Bureau of Land Management
LANDS/RECREATION & PLANNING
ONE N CENTRAL AVE
PHOENIX, AZ 85004 -2203
Phone: 602-417-9200**

Receipt

No: 3258281

Transaction #: 3353701	
Date of Transaction: 03/26/2015	
CUSTOMER:	
LARRY SELBERG PO BOX 7434 CHANDLER, AZ 85246-7434 US	

LINE #	QTY	DESCRIPTION	REMARKS	UNIT PRICE	TOTAL
1	1.00	LOCATABLE MINERALS / MINING CLAIMS- NOT NEW-UNADJUD, ONE AUTH NO. ONLY / MINING CLAIM MONEY RECEIVED CASES: AMC418635/\$775.00	2016 MAINT (5)	- n/a -	775.00
TOTAL:					\$775.00

PAYMENT INFORMATION			
1	AMOUNT:	465.00	POSTMARKED: N/A
	TYPE:	CHECK	RECEIVED: 03/26/2015
	CHECK NO:	9389	
	NAME:	SELBERG, LARRY	
2	AMOUNT:	155.00	POSTMARKED: N/A
	TYPE:	CHECK	RECEIVED: 03/26/2015
	CHECK NO:	9390	
	NAME:	SELBERG, LARRY	
3	AMOUNT:	155.00	POSTMARKED: N/A
	TYPE:	CHECK	RECEIVED: 03/26/2015
	CHECK NO:	9391	
	NAME:	SELBERG, LARRY	

REMARKS

This receipt was generated by the automated BLM Collections and Billing System and is a paper representation of a portion of the official electronic record contained therein.

MAY - 1 2015
BY: RAM



Brown, Pauline <paulinebrown@blm.gov>

Your request for my maintenance payment forms

2 messages

Fri, May 1, 2015 at 11:39 AM

Larry Selberg <l_selberg@yahoo.com>
Reply-To: Larry Selberg <l_selberg@yahoo.com>
To: "paulinebrown@blm.gov" <paulinebrown@blm.gov>

Pauline Brown

Attached are the Maintenance Fee Payment forms that you called me about (Forms MCF112). One form has three (3) claims cited on it "Gold Gulch" 424428, "Havalina #1" 423147, and "Havalina #2" 423148. The other three forms have one claim cited on each form. "Dream Catcher" 418635 on one form, "Billie R" 418698 on another form, and "Lucky Lady" 418634 on the last form. All were paid on March 26, 2015. PLEASE CALL ME IF YOU CAN NOT ACCESS THESE DOCUMENTS, AND I WILL FAX THEM TO YOU. THANK YOU SO MUCH FOR YOUR HELP, MY CEL PHONE IS (480) 789-2863.

LARRY SELBERG

4 attachments

- IMG_20150501_0002.pdf [3-CLAIMS: AMC 424428, AMC 423147-148] For Receipt # 3258281
557K
- IMG_20150501_0003.pdf [1-CLAIM: AMC 418635] For Receipt # 3258281
532K
- IMG_20150501_0004.pdf [1-CLAIM: AMC 418698] For Receipt # 3258281
528K
- IMG_20150501_0005.pdf [1-CLAIM: AMC 418634] For Receipt # 3258258
547K

Brown, Pauline <paulinebrown@blm.gov>
To: Larry Selberg <l_selberg@yahoo.com>

Fri, May 1, 2015 at 12:00 PM

Thank you Sir,

I will print the attached documents and have the payments processed today.

Regards,

PAULINE BROWN
LAND LAW EXAMINER
BUREAU OF LAND MANAGEMENT
ARIZONA STATE OFFICE
ONE NORTH CENTRAL AVE, STE 800
PHOENIX, AZ 85004-4427
OFFICE: (602) 417-9360
FAX: (602) 417-9490; 602-417-9452
paulinebrown@blm.gov
[Quoted text hidden]

Customer Name Update Screen

System ID:MC

Name: SELBERG LARRY

Proprietor #: 2339334

Category: P - PRIVATE ▾

Address: PO BOX 7434

City: CHANDLER

State: AZ ▾

Zip: 852467434

UNDELIVERABLE

Email: l_selberg@yahoo.com

Phone: 480-789-2863

Lookup

Renumber To:

Save

Save/Override DataFlux

Delete

Renumber

Customer details successfully saved for Customer Id 2339334

AMC 424428

423147

787

MAINTENANCE FEE PAYMENT

Claimant Name: LARRY SELBERG

Address: P.O. Box 7434

City: CHANDLER State: AZ Zip: 85246

Telephone: (480) 789-2863

E-mail address: L - SELBERG

Signature: Larry Selberg

Check here if this is a change of address.

RECEIVED
 BLM AZ STATE OFFICE
 PHOENIX, ARIZONA
 2014 JUL 29 P 1:21

BLM
Date
Stamp

LINE NO.	AMC NUMBER	CLAIM/SITE NAME	COUNTY RECORDER DATA (If available)	TWP	RNG	SEC
1	424428	GOLD GULCH	2013-0042647	9N	5W	13
2	423147	HAVALINA#1	2013-0029335	9N	5W	13
3	423148	HAVALINA#2	2013-0029337	9N	5W	13
4						
5						
6						
7						
8						
9						
10						

List additional claims on Form MCF114.

Bureau of Land Management
Arizona State Office
www.blm.gov/az/

No. of Claims: 3 x 155 = 465.00
 Check No: 9337 Init. ESG
 Receipt No.: 3087922
 For BLM Use Only

Form: MCF112
Revised July 2009

This form is available from the Arizona Department of Mines and Mineral Resources and may be reproduced.

ENTERED
 JUL 31 2014
 BY: RAM

United States Department of the Interior
Bureau of Land Management
 LANDS/RECREATION & PLANNING
 ONE N CENTRAL AVE
 PHOENIX, AZ 85004 -2203
 Phone: 602-417-9200



Receipt

No: 3087922

Transaction #: 3179283	
Date of Transaction: 07/29/2014	
CUSTOMER:	
LARRY SELBERG PO BOX 7434 CHANDLER, AZ 85246-7434 US	

LINE #	QTY	DESCRIPTION	REMARKS	UNIT PRICE	TOTAL
1	1.00	LOCATABLE MINERALS / MINING CLAIMS- NOT NEW-UNADJUD, ONE AUTH NO. ONLY / MINING CLAIM MONEY RECEIVED CASES: AMC424428/\$465.00	2015 MAINT (3)	- n/a -	465.00
TOTAL:					\$465.00

PAYMENT INFORMATION			
1	AMOUNT:	465.00	POSTMARKED: N/A
	TYPE:	CHECK	RECEIVED: 07/29/2014
	CHECK NO:	9337	
	NAME:	SELBERG, LARRY PO BOX 7434 CHANDLER AZ 85246-7434 US	

REMARKS

This receipt was generated by the automated BLM Collections and Billing System and is a paper representation of a portion of the official electronic record contained therein.

NOTICE!!

These documents have been scanned!

Do not place un-scanned documents beneath this notice!

Do not remove this notice from this file!

GPO Jacket No. 560-102
Print Order 61540
Rise Business Services, LLC
Job=AZ15 5/13/2019



Box Number= AZ15038



Claim Begin-End: AMC424428-AMC424428

6 Location Notices-Amendments and Supporting Documents



AZ15038-8

AMC423774-AMC424570

**DEPARTMENT OF THE INTERIOR
BUREAU OF LAND MANAGEMENT
MINING CLAIMS**

(LIVE) Serial Register Page

Run Date/Time: 09/03/2013 12:15 PM

Page 1 of 1

01 10-21-1976;090STAT0090;43USC1744

Total Acres

Serial Number

Case Type 384201: PLACER CLAIM

20.000

AMC424428

Claim Name: GOLD GULCH

Lead File Number

Commodity :

AMC424428

Case Disposition: ACTIVE

Required Maintenance Fee: \$140.00

Name & Address	Int Rel
LENSING WANDA PO BOX 778	CONGRESS, AZ 85332-0778 CLAIMANT
RUCKER BILLIE 1866 JOHNS RUN	GRAYSON, KY 41143-7773 CLAIMANT
RUCKER CAROL 1866 JOHNS RUN	GRAYSON, KY 41143-7773 CLAIMANT
COULTER BILL 254 GRIFFIN RD	HELENA, MT 59602-9415 CLAIMANT
COULTER KAREN 254 GRIFFIN RD	HELENA, MT 59602-9415 CLAIMANT
GENTRY DANIEL 45430 W LURAY RD	WICKENBURG, AZ 85390-2157 CLAIMANT
GENTRY NANCY 45430 W LURAY RD	WICKENBURG, AZ 85390-2157 CLAIMANT
CURRY ANTHONY L PO BOX 26	CONGRESS, AZ 85332-0026 CLAIMANT
CURRY JUDY K PO BOX 26	CONGRESS, AZ 85332-0026 CLAIMANT
LENSING EUGENE PO BOX 778	CONGRESS, AZ 85332-0778 CLAIMANT
SELBERG GEORGINA PO BOX 7434	CHANDLER, AZ 85246-7434 CLAIMANT
SELBERG LARRY PO BOX 7434	CHANDLER, AZ 85246-7434 CLAIMANT

Mer Twp	Rng	Sec	Quadrant	District/Field Office	County
14	0090N	0050W	013 NE	HASSAYAMPA FO	YAVAPAI

Act Date	Code	Action	Action Remarks	Receipt Number
04/27/2013	403	LOCATION DATE		
07/25/2013	395	RECORDATION NOTICE RECD	1	2839960
07/25/2013	682	MAINTENANCE FEE/\$140	2014;\$140	2839960
07/25/2013	484	LOCATION YEAR / MAINTENANCE	2013;\$140	2839960
07/25/2013	501	ACCT ADV IN LEAD FILE	AMC424428;	
07/24/2013	404	COUNTY RECORDATION	0;4971;318	

Line Nr Remarks

NO WARRANTY IS MADE BY BLM
FOR USE OF THE DATA FOR
PURPOSES NOT INTENDED BY BLM

ENTERED
SEP 03 2013
DATA
ENTERED
BY: 25 July 2013

MINING CLAIM STATUS REPORT

MTP Checked by nch
GEO Checked by nch

LEAD SERIAL NUMBER AMC 424428 thru AMC _____

OF CLAIMS & TYPE

_____ LODE
1 PLACER
_____ ASSOCIATION PLACER
_____ MILL SITE
_____ TUNNEL SITE

CHARGES

Location Fee @ \$34 = \$ 34
Processing Fee @ \$15 = \$ 15
Maintenance Fee @ \$140 = \$ 140
Overage (+) \$ _____
Shortage (-) \$ _____
Other Fees \$ 140.00
2014 maint.
TOTAL \$ ~~189~~ 329.00

TOTAL CLAIM ACREAGE? 20
OF LOCATORS? 12

DOCUMENTS RECEIVED VIA -

Over-the-Counter Mail

TIMELY FILED?

Yes No

LEGAL DESCRIPTION - T 9N R 5W SEC 13
T _____ R _____ SEC _____
T _____ R _____ SEC _____
T _____ R _____ SEC _____

BLM FOREST SERVICE SUBJ TO PL 359: Yes No
WILDERNESS AREA: No Yes

SPLIT ESTATE - N/A SX PX SRHA OTHER
Proper Notice Filed if Located on SHRA Lands? N/A Yes No

RECONVEYED MINERALS ON BLM LANDS REQUIRE OPENING ORDERS FROM 1944 TO 1993 -

Open to Entry on: _____ N/A

COMMENTS/STATUS - VOID PARTIALLY VOID PVT MINERALS WITHDRAWN LANDS
OTHER

Claimant acknowledges that portions of the following claims(s) site(s) may be void or voidable.

Printed Name of Claimant _____ Signature of Claimant _____

***** FINAL ADJUDICATION *****

DATE 12/27/2013 INITIALS TS

AMC 424428

RETURN TO:

LARRY SELBERG
P.O. Box 7434
CHANDLER, AZ 85246-7434



LOCATION NOTICE FOR PLACER MINING CLAIM

NOTICE IS HEREBY GIVEN that the GOLD GULCH

_____ placer mining claim has been located by

LARRY SELBERG ETAL. whose current mailing

address is P.O. Box 7434

CHANDLER, AZ 85246-7434

RECEIVED
BLM, AZ STATE OFFICE
2013 JUL 25 P 1:51
PHOENIX, AZ
BLM
Date
Stamp

The general course of this claim is A NORTH TO SOUTH and it is situated in
YAVAPAI County, Arizona. RECTANGIE

This claim is 1320 feet in length and 660 feet in width. This claim runs from the location monument on which this location notice is posted approximately 1320 feet in a Southerly direction to the SOUTH end line and 660 feet in a WESTERly direction to the WEST end line.

This claim is marked by four monuments, one at each corner of the claim.

The location monument on which this notice is posted is situated within Section 13, Township 9 N, Range 5 W, Gila Salt River Base and Meridian, Arizona. This claim encompasses portions of the following legal subdivision(s) if located by legal subdivision or the following quarter section (s), section (s), Township (s) and Range (s) PORTION OF THE NW 1/4 NE 1/4 SECTION 13, T9N, R5W, Gila Salt River Base and Meridian, Arizona.

The locality of this claim with reference to some natural object or permanent monument and additional information (if any) concerning its locality are as follows: THE NW CORNER IS AT QUARTER SECTION MARKER #161 S12/S13 1/4.

DATED AND POSTED on the ground this 27TH day of APRIL, 2013.

LOCATOR (s) Larry C Selberg

Form MCF102
Revised July 2005

AR0424428

MINING CLAIM MAP

Lode () Placer (X)

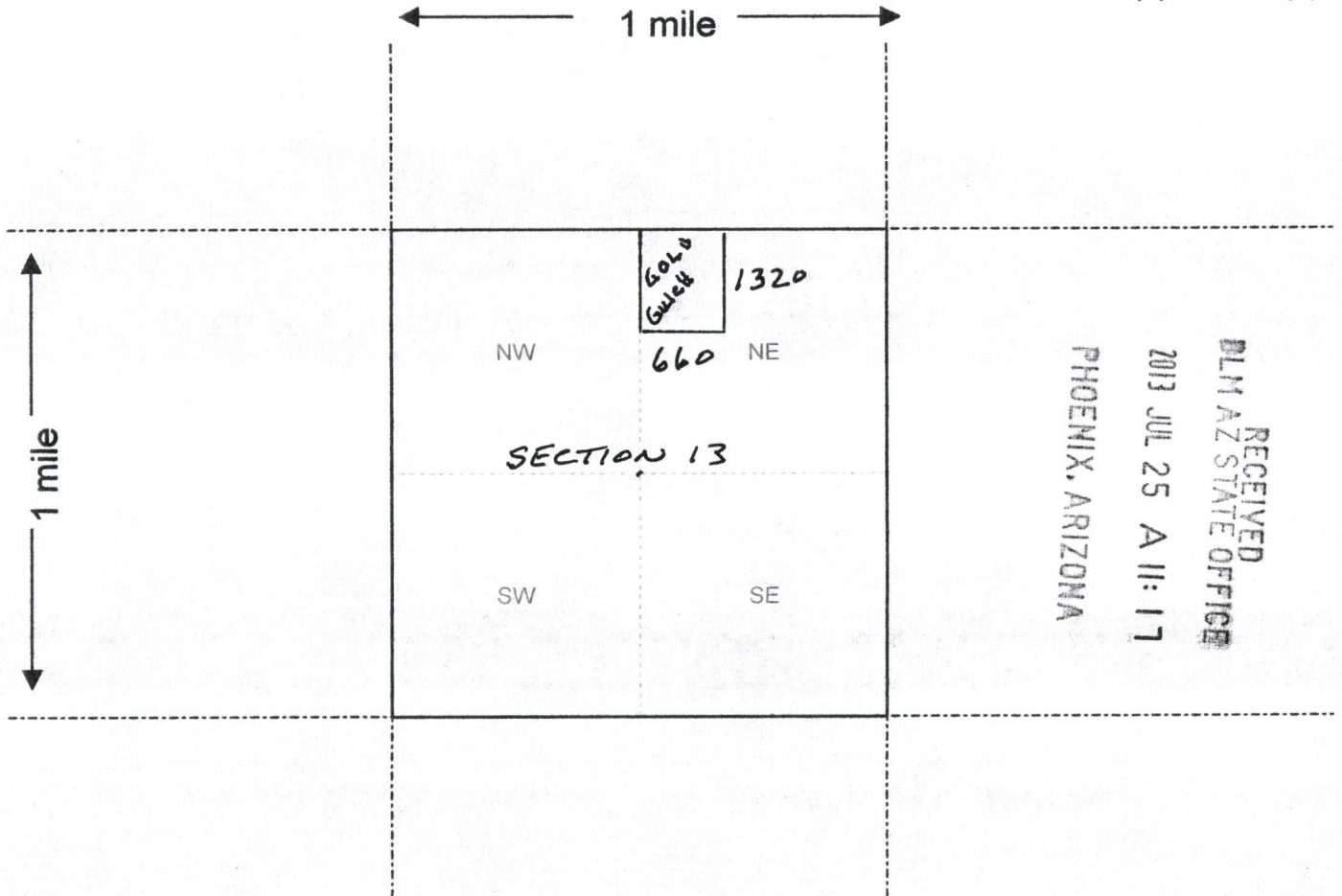

RECEIVED
BLM AZ STATE OFFICE
2013 JUL 25 A 11:17
PHOENIX, ARIZONA

Scale : 1" = 2000 feet



1. The above map depicts the GOLD GULCH mining claim, which is located in Section (s) 13, Township 9 N, Range 5 W, Gila and Salt River Base and Meridian, YAVAPAI County, Arizona.
2. The type of corner and location monuments used are as follows: 2" PVC PIPE WITH TOP CAP AND NAME TAGS
3. The bearings and distances in degrees and feet between claim corners are as depicted on the map.

A PORTION OF THE NW 1/4 NE 1/4 SECTION 13, T9N AND R5W GSR B & M, AZ. Form MCF100a
Revised July 2005

12 Claimants for the Gold Gulch Claim

COULTER, BILLY
254 GRIFFIN RD. HELENA, MT 59602-9415

COULTER, KAREN
254 GRIFFIN RD. HELENA, MT 59602-9415

CURRY, ANTHONY L
PO BOX 26, CONGRESS, AZ 85332-0026

CURRY, JUDY K
PO BOX 26, CONGRESS, AZ 85332-0026

GENTRY, DANIEL
45430 W LURAY RD., WICKENBURG, AZ 85390-0026

GENTRY, NANCY
45430 W LURAY RD., WICKENBURG, AZ 85390-0026

LENSING, EUGENE
PO BOX 778 CONGRESS, AZ 85332-0778

LENSING, WANDA
PO BOX 778 CONGRESS, AZ 85332-0778

RUCKER, BILLIE
1866 JOHNS RUN, GRAYSON, KY 41143-7773

RUCKER, CAROL
1866 JOHNS RUN, GRAYSON, KY 41143-7773

SELBERG, LARRY C
PO BOX 7434 CHANDLER, AZ 85246-7434

SELBERG, GEORGINA A
PO BOX 7434 CHANDLER, AZ 85246-7434

RECEIVED
B.L.M. AZ STATE OFFICE
2013 JUL 25 P 1:51
PHOENIX, AZ

AMC1424428

RECEIVED STATE
BUREAU OF LAND MANAGEMENT

U.S. DEPARTMENT OF THE INTERIOR
BUREAU OF LAND MANAGEMENT
PHOENIX, ARIZONA

RECEIVED
BUREAU OF LAND MANAGEMENT
PHOENIX, ARIZONA



APC0420428

RECEIVED
B.L.M. AZ STATE OFFICE

2013 JUL 25 P 1:51

PHOENIX, AZ

STATE OF ARIZONA
County of Yavapai

LESLIE M. HOFFMAN, County Recorder, in and for the County of Yavapai, State of Arizona, and custodian of the records of such office, do hereby certify that the foregoing is a full, true and correct copy of the record as same appears in my office.

IN WITNESS WHEREOF, I have hereunto set my hand and affixed my official seal in the City of Prescott, County of Yavapai, State of Arizona, on this the 24th day of July, A.D. 2013



Linda S. Holland
Deputy Recorder

RUN TIME: 02:44 PM

DEPARTMENT OF INTERIOR
BUREAU OF LAND MANAGEMENT

RUN DATE: 07/25/2013

Input Parameters for Geographic Report with Land

System Id = CR

Admin State = AZ

Geo State =

Casetype =

Casetype Txt =

Case Disp Txt = AUTHORIZED, CANCELLED, EXPIRED, PENDING, REJECTED, RELINQUISHED

Mer Twp Rng =

Mtrs = 14 0090N 0050W 013, 14 0090N 0050W 999

Commodity =

Commodity Txt =

Adm Agency Begins With

Total Rows Returned: 5

NO WARRANTY IS MADE BY BLM FOR USE OF THE DATA
FOR PURPOSES NOT INTENDED BY BLM

RUN DATE: 07/25/13 02:43 PM
STATE: AZ

UNITED STATES DEPARTMENT OF THE INTERIOR
BUREAU OF LAND MANAGEMENT
GEOGRAPHIC REPORT WITH LAND
SORTED BY MTR

Serial Number: AZA 032939
Total Case Acres: 1

<u>Casetype</u>	<u>Case Disp</u>	<u>Mer</u>	<u>Twp</u>	<u>Rng</u>	<u>SEC</u>	<u>SUR TYPE</u>	<u>SUR NR</u>	<u>SUF</u>	<u>SUBDIVISION</u>	<u>ACT PEND</u>
293200	AUTHORIZED	14	0090N	0050W	013	1			PORTION OF;	

Serial Number: AZA 034832
Total Case Acres: 5

<u>Casetype</u>	<u>Case Disp</u>	<u>Mer</u>	<u>Twp</u>	<u>Rng</u>	<u>SEC</u>	<u>SUR TYPE</u>	<u>SUR NR</u>	<u>SUF</u>	<u>SUBDIVISION</u>	<u>ACT PEND</u>
380913	PENDING	14	0090N	0050W	013	1			E2;	

Serial Number: AZA 035210
Total Case Acres: 1

<u>Casetype</u>	<u>Case Disp</u>	<u>Mer</u>	<u>Twp</u>	<u>Rng</u>	<u>SEC</u>	<u>SUR TYPE</u>	<u>SUR NR</u>	<u>SUF</u>	<u>SUBDIVISION</u>	<u>ACT PEND</u>
293200	AUTHORIZED	14	0090N	0050W	013	1			PORTIONS OF;	

Serial Number: AZAR 0000110
Total Case Acres: 16.66

<u>Casetype</u>	<u>Case Disp</u>	<u>Mer</u>	<u>Twp</u>	<u>Rng</u>	<u>SEC</u>	<u>SUR TYPE</u>	<u>SUR NR</u>	<u>SUF</u>	<u>SUBDIVISION</u>	<u>ACT PEND</u>
285003	AUTHORIZED	14	0090N	0050W	013	A			E2NE,SWNE,W2SE;	

Serial Number: AZAR 0034626
Total Case Acres: 26.55

Mer Twp Rng

RUN DATE: 07/25/13 02:43 PM
STATE: AZ

UNITED STATES DEPARTMENT OF THE INTERIOR
BUREAU OF LAND MANAGEMENT
GEOGRAPHIC REPORT WITH LAND
SORTED BY MTR

Page 2 of 2

Serial Number: AZAR 0034626
Total Case Acres: 26.55

<u>Casetype</u>	<u>Case Disp</u>				<u>SEC</u>	<u>SUR TYPE</u>	<u>SUR NR</u>	<u>SUF</u>	<u>SUBDIVISION</u>	<u>ACT PEND</u>
286202	AUTHORIZED	14	0090N	0050W	013	A			E2W2;	

NO WARRANTY IS MADE BY BLM FOR USE OF THE DATA FOR PURPOSES NOT INTENDED BY THE BLM

